



Vanbon万铂®
上海万铂起重机械有限公司
SHANGHAI WANBO HOISTING MACHINERY CO.,LTD.

地址：上海市嘉定区丰功路628号

电话：021-59158818 59158828

传真：021-69151468

Add: NO.628,Fenggong Road, Jiading Shanghai, PRC

Tel: +86-21-59158818 +86-21-59158828

Fax: +86-21-69151468

[Http://www.vanbonhoist.com](http://www.vanbonhoist.com) www.vanbonhoist.cn

本产品目录中所登录的产品，均按其使用目的，依照相关法规、规格所规定的功能及性能进行设计。用户在使用过程中，如果使之组装于机器设备中，或其他预料不到的情况下使用，而造成产品性能，功能的下降，或因不可预料的使用而引发的事故，本公司将不承担任何责任，如需特殊用途下使用时，请事先与本公司技术部门联系确认。

本资料为中英文对照版本，如有含义冲突或不明确时，以中文为准。

由于公司坚持在产品开发中不断改进的原则，因此产品的规格可能有所变更，恕不另行通知。

The products entered in this catalog of products are all designed according to their application purposes, in compliance with functions and performances stipulated in related legal regulations and specifications. Our Company shall undertake no responsibility at all for any deterioration of product performances or functions due to user assembly of them in machines and equipments, or application of them under other unexpected situations during use or for any accidents arising from unexpected use.

Please contact technical department of our Company for confirmation in advance when application for special purposes is required.

This direction made of in Chinese and English, in event of conflicts or imcertainty of meaning, the Chinese version shall prevail.

For modification of product specification subjects to continuous betterment in development of vanbon products, no notice will be given separately.

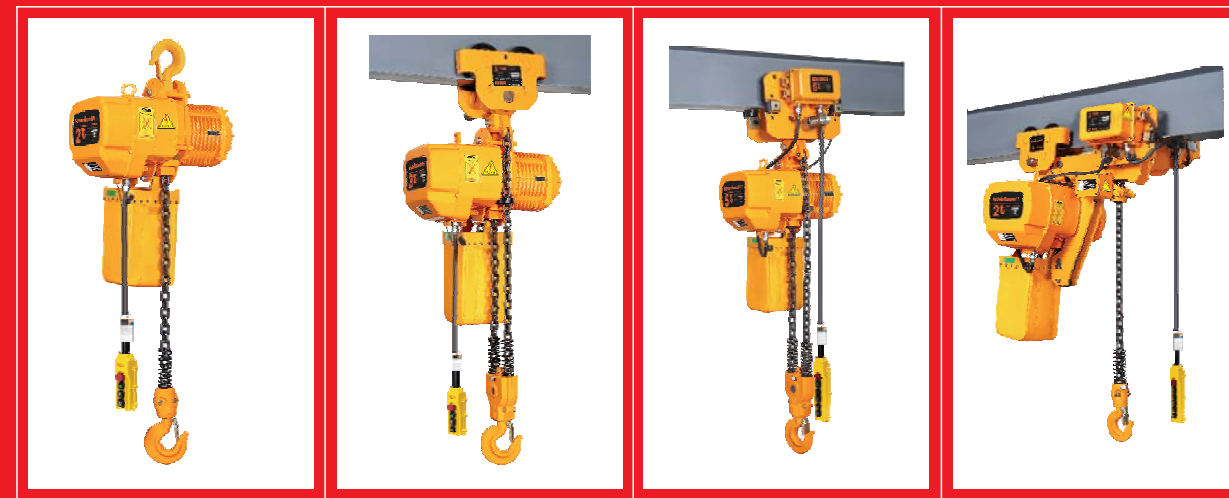

[Http://www.vanbonhoist.com](http://www.vanbonhoist.com) www.vanbonhoist.cn

CONTENTS

目录

[Http://www.vanbonhoist.com](http://www.vanbonhoist.com) www.vanbonhoist.cn



安全可靠、便捷高效 是我们对您永久的承诺
Reliability, efficiency, our permanent commitment

COMPANY PROFILE

公司简介

上海万铂起重机械有限公司位于上海嘉定区工业园，是一家集设计、生产和销售为一体的专业制造商，主要产品为：环链电动葫芦、起重电机、欧式端梁、单/双轨台车等起重机械及相关配件。公司拥有完善的质量管理体系、高素质人才队伍、先进的设计理念、高效的生产、加工和检测设备，并将ERP等计算机系统运用于管理实践中。

公司目前已通过ISO9001国际质量体系认证、欧盟CE安全认证、以及SGS等认证。公司拥有一支专业精干的质量控制团队，每一位员工都要接受相关专业的培训且十分强调员工对工作细节的关注。

公司配有涂装、装配、机加工、微机测控台等先进设备和专业检测装置。“质量第一”是我们的责任，“客户至上，勇于创新”是我们的经营理念，“致力于不断为客户提供值得信赖的解决方案和加工制造服务”是我们信奉并遵循的宗旨，把“Vanbon万铂”品牌打造成为国内一流，国际知名的品牌是我们始终坚持的目标。

我们热诚期待与您合作并建立长期友好的合作伙伴关系！

Shanghai Wanbo Hoisting Machinery Co., Ltd. specializes in manufacturing, supplying and exporting a premium quality range of lifting equipment like Electric Chain Hoist, Crane motor European End Truck, Single/Double-track Trolley and related accessories.

VANBON has a modern factory of 56,000 square meters in Jiading Industrial Zone, which is 30 minutes' visit from Shanghai Hongqiao Airport.

Since quality is our first priority, Vanbon has completely achieved Quality Control System approvals such as ISO9001:2008, European CE and SGS which make the stable quality of products, we have more than 8 years' experience in R & D and production, scientific management system, advanced production technology and strict quality control ensure us to be ahead of the lifting industry.

We strongly believe that company improvement can be accelerated by developing its people, so we make sure our human team shall accept the professional training and be dedicated to the work details. Following the concepts of "better quality and continuous innovation", we are dedicated to providing reliable solutions and products for our clients.

We sincerely welcome all the clients over the world to establish long-term cooperative relationship with us.

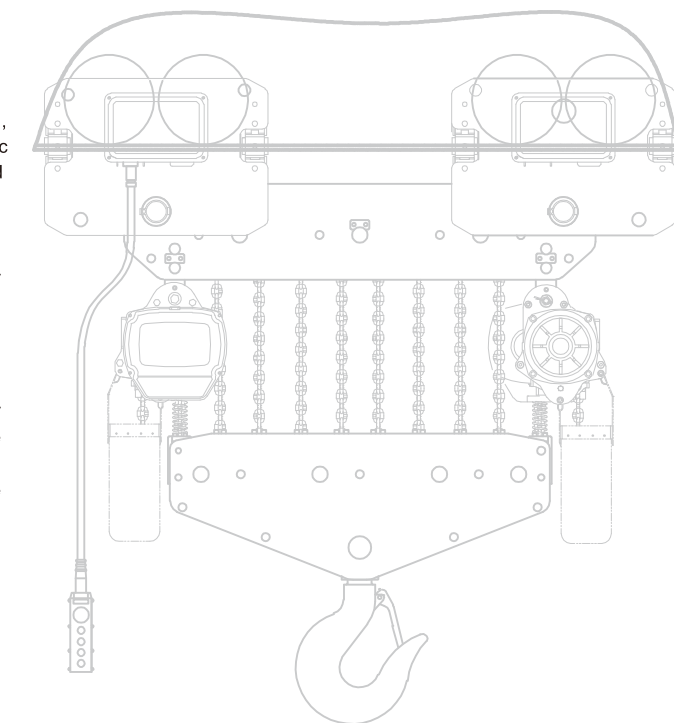

- 01 产品编码，吊钩及链条规格
Product Code, Hook & Chain Specifications
- 02 产品结构图解
Product Structure
- 03 挂钩式环链电动葫芦 300Kg-10Ton
Hook Suspension Type Electric Chain Hoist
- 05 电动运行式环链电动葫芦 300Kg-10Ton
Motorized Trolley Type Electric Chain Hoist
- 07 手动运行式环链电动葫芦300kg-5Ton
Manual Trolley Type Electric Chain Hoist
- 08 固定式环链电动葫芦 15Ton-35Ton
Fixed Type Electric Chain Hoist
- 09 电动运行式环链电动葫芦15Ton-25Ton
Motorized Trolley Type Electric Chain Hoist
- 10 挂钩式环链电动葫芦 100Kg-400Kg
Hook Suspension Type Mini Electric Chain Hoist
- 11 低净空型环链电动葫芦 500Kg-10Ton
Low Headroom Type Electric Chain Hoist
- 13 电动小车/手动小车
Motorized Trolley / Manual Trolley
- 14 环链电动葫芦配件
Electric Chain Hoist Parts
- 15 起重机电机
Crane Geared Motor
- 17 起重机端梁/ 双轨台车
Top Running End Trucks/ Double Girder Top Running Type Motorized Trolley
- 18 倒悬挂端梁/ 起重机轮
Underhung Single Girder End Trucks/ Machined Steel End Trucks Wheels
- 19 KBK 柔性轻型组合式悬挂起重机/悬臂起重机
KBK Light Crane System / Jib Crane
- 20 工厂一览 / 工程案例
Factory / Cases



产品代码 Products Code

WBH - 010		01		S		E	
Products Series 产品系列							
Capacity 额定载荷		Falls 链条回数		Speed Type 速度形式			
Code 代码	Load 额定载荷(t)	Code 代码	Falls 链条回数	S 单速 Single Speed	D 双速 Dual Speed	F Hook Suspension type 挂钩式	M Manual Trolley Type 手动小车运行式
001	0.1	01	1				
002	0.2	02	2				
003	0.3	03	3				
004	0.4	04	4				
005	0.5	06	6				
010	1	08	8				
015	1.5	10	10				
020	2	12	12				
025	2.5	16	16				
030	3						
050	5						
075	7.5						
100	10						
150	15						
200	20						
250	25						
300	30						
350	35						

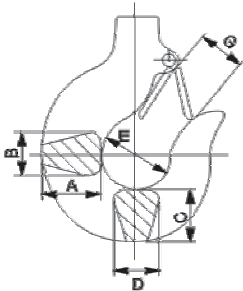

Hook 吊钩

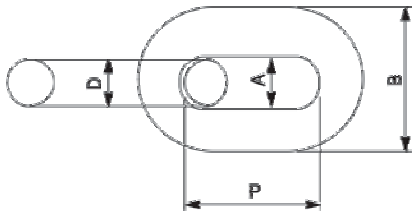

Chain 链条

日本原装进口FEC G80链条
FEC G80 Chain imported from Japan

Type 机型	Load 负重(t)	T B	A	B	C	D	E	G
WBH	0.2, 0.3, 0.5	T B	27	18	25	17	35	28
	1	T B	34	24	30	24	42	32
	2	T B	46	29	39	30	49	40
	3	T B	56	35	49	34	59	48
	5	T B	67	43	57	44	60	48
	7.5	T B	82	55	80	48	85	80
	10	T B	82	55	80	48	85	80
	15	T B	110	78	120	80	120	96
	20, 25	T B	142	95	155	98	150	115
	30	T B	160	130	150	130	140	95
	35	T B	195	150	160	150	160	110

T-top hook/B-load hook

T-上吊钩/B-下吊钩

Applicable Type 使用机型	Diameter 直径(mm)D	Inside Length 节距(mm)P	Inside Width 内宽(mm)A	Outside Width 外宽(mm)B	Work Load 工作负荷(kg)	Guaranteed Load 保证负荷(kN)	Break Load 最大破断负荷(kN)
WBH-00201	5.0	16	6.9	19	400	17	27
WBH-00301	6.3	19	7.9	22	1120	27	47
WBH-00501	6.3	19	7.9	22	1120	27	47
WBH-01001	7.1	21	8.9	25	1600	37	61.6
WBH-02002	7.1	21	8.9	25	1600	37	61.6
WBH-03003	7.1	21	8.9	25	1600	37	61.6
WBH-01501	10.0	30	12.5	35	3200	76	125
WBH-02001	10.0	30	12.5	35	3200	76	125
WBH-03002	10.0	30	12.5	35	3200	76	125
WBH-02501	11.2	34	14	37.5	3800	92	154
WBH-03001	11.2	34	14	37.5	3800	92	154
WBH-05002	11.2	34	14	37.5	3800	92	154
WBH-07503	11.2	34	14	37.5	3800	92	154
WBH-10004	11.2	34	14	37.5	3800	92	154
WBH-15006	11.2	34	14	37.5	3800	92	154
WBH-20008	11.2	34	14	37.5	3800	92	154
WBH-25010	11.2	34	14	37.5	3800	92	154
WBH-30012	11.2	34	14	37.5	3800	92	154
WBH-35016	11.2	34	14	37.5	3800	92	154

Shell:It is made of light aluminum alloy shell,light but hard. The cooling fin is especially designed to ensure quick heat dissipation with the rate up to 40% and continuous service. The integral enclosed structure is applicable to places like chemical plant and electroplate factory.

外壳: 铝合金外壳，坚实而质轻。有特殊散热片，散热快，可连续使用，效率达40%。整体密闭式结构，可使用在化工厂、电镀厂等地方。

Side magnetic braking device: The magnetic orce generator is the latest design which is featured for generating magnetic force. It allows instant brake as soon as the electric power is cut off. Thus the braking safety while loading is guaranteed.

旁磁刹车: 最新设计的磁力产生器，其特性为产磁。可在电源切断的同时间刹车，保证吊重时刹车绝对确保安全。

Limit switch:The limit switch device is installed where the weight is lifted on and off to make the motor to stop automatically so as to prohibit the chains from exceeding for safety.

极限开关: 吊上吊下都有极限开关装置，使自动停止，防止链条超出，确保安全。

Chain:The chain shall adopt the imported FEC G80 ultra heat-treatable aluminum alloy chain. It can be safely used in poor environments such as rain, sea water and chemicals.

链条: 采用进口 FEC G80 超级加热处理合金钢链条。在雨水、海水、化学品及其他恶劣状况下使用安全无虑。

Hook:It is hot forging with perfect strength that is hard to break. The operation safety of the lower hook is ensured by its 360 degrees rotation and safety flap.

吊钩: 经热锻造，强度绝佳，不易断裂。下吊钩可360° 旋转，附安全舌片，确保操作安全。

Support frame: The loading support frame consists of two steel plates, which is extremely sturdy.

支撑架: 吊重支撑架由两片钢板组合，非常坚固。

Transformer: 24V/36V/48V/110V transformer device. This device is used to prohibit unexpected accidents caused by electric leakage and guarantees the safe use while raining.

变压器: 24V/36V/48V/110V变压装置。操作时，万一漏电，可防止意外事故发生，下雨时，可保证安全使用。

Electromagnetic contactor: Electromagnetic contactor can be used safely under high frequency.
电磁接触器: 高效率电磁接触器。可高频率使用，没有问题。

Inverse phases sequence protecting device: It is the special electrical installation which controls the circuit not to work in case of wiring error in the power supply.

逆相保护装置: 特殊电气装置，当电源接线错误时，控制电路无法动作。

Control switch: Waterproof push button is applied. It is light and durable.

按钮开关: 使用防水按钮开关，轻便耐用。

Standard Accessories: Chain bag(1) Control cable (3m) Push-button switch (1)

标准配件: 链条袋(1个) 控制电缆(3m) 按钮开关(1只)

300Kg–10Ton

挂钩式环链电动葫芦

Hook Suspension Type Electric Chain Hoist

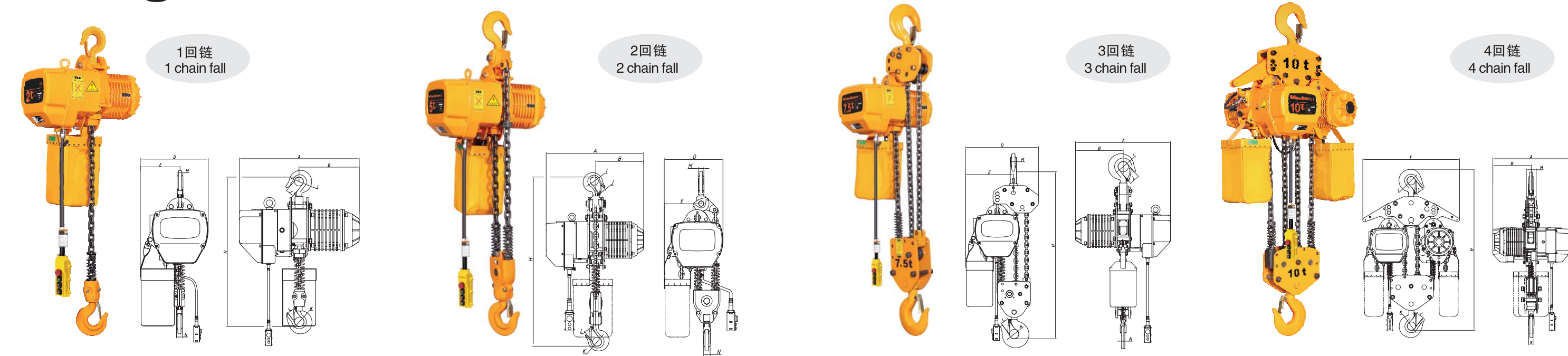

Technical Parameters 技术参数

Type 型号	Capacity 额定起重量(t)	Lifting Speed 起升速度 (m/min)	起升电机 Lifting Motor					Chain Falls 链条回数	Chain Spec 链条规格	Test Load 试验载荷(t)	Weight 净重(Kg)	Weight Added with 1m Higher 扬程每增加1m 应加重量(Kg)
			Power 功率(kW)	Rotation Speed 转速(r/min)	Phases 相数	Voltage 电压(V)	Frequency 频率(Hz)					
WBH-00301SF	0.3	7.1	0.75	1440	3	200-460	50/60	1	φ 6.1	0.375	40	0.61
WBH-00501SF	0.5	6.8	0.75	1440	3	200-460	50/60	1	φ 6.3	0.625	47	0.81
WBH-01001SF	1	6.6	1.5	1440	3	200-460	50/60	1	φ 7.1	1.25	61	1.1
WBH-01002SF	1	3.4	0.75	1440	3	200-460	50/60	2	φ 6.3	1.25	52	1.62
WBH-01501SF	1.5	8.8	3.0	1440	3	200-460	50/60	1	φ 10.0	1.875	108	2.3
WBH-02001SF	2	6.6	3.0	1440	3	200-460	50/60	1	φ 10.0	2.5	115	2.3
WBH-02002SF	2	3.3	1.5	1440	3	200-460	50/60	2	φ 7.1	2.5	73	2.2
WBH-02501SF	2.5	5.4	3.0	1440	3	200-460	50/60	1	φ 11.2	3.125	116	2.8
WBH-03001SF	3	5.4	3.0	1440	3	200-460	50/60	1	φ 11.2	3.75	122	2.8
WBH-03002SF	3	4.4	3.0	1440	3	200-460	50/60	2	φ 10.0	3.75	131	4.7
WBH-03003SF	3	2.2	1.5	1440	3	200-460	50/60	3	φ 7.1	3.75	85	3.3
WBH-05002SF	5	2.7	3.0	1440	3	200-460	50/60	2	φ 11.2	6.25	151	5.6
WBH-07503SF	7.5	1.8	3.0	1440	3	200-460	50/60	3	φ 11.2	9.4	266	8.4
WBH-10004SF	10	2.7	3.0x2	1440	3	200-460	50/60	4	φ 11.2	12.5	300	8.4

Size Specification 尺寸规格表

Type 型号	H	A	B	D	E	I	J	K	L	M	N
WBH-00301SF	600	415	168	280	195	φ 34	28	φ 34	28	19	19
WBH-00501SF	550	460	230	280	160	φ 35	25	φ 35	25	17	17
WBH-01001SF	650	520	260	300	176	φ 40	31	φ 40	31	22	22
WBH-01002SF	670	460	230	280	205	φ 40	31	φ 40	31	22	22
WBH-01501SF	800	615	295	430	265	φ 47	40	φ 47	38	30	30
WBH-02001SF	800	615	295	430	265	φ 47	40	φ 47	38	30	30
WBH-02002SF	835	520	260	300	236	φ 47	38	φ 47	38	30	30
WBH-02501SF	845	615	295	430	265	φ 58	47	φ 58	47	36	36
WBH-03001SF	845	615	295	430	265	φ 58	47	φ 58	47	36	36
WBH-03002SF	950	615	295	430	320	φ 58	47	φ 58	47	36	36
WBH-03003SF	950	520	260	350	205	φ 59	48	φ 59	48	35	35
WBH-05002SF	1030	615	295	430	325	φ 60	48	φ 60	48	43	43
WBH-07503SF	1200	615	295	505	320	φ 54	φ 31	φ 85	80	85	55
WBH-10004SF	1400	630	315	/	890	φ 85	80	φ 80	80	104	55

单速 Single Speed

单速 Single Speed

Technical Parameters 技术参数

Type 型号	Capacity 额定起重量(t)	Lifting Speed 起升速度 (m/min)	起升电机 Lifting Motor					Chain Falls 链条回数	Chain Spec 链条规格	Test Load 试验载荷(t)	Weight 净重(Kg)	Weight Added with 1m Higher 扬程每增加1m 应加重量(Kg)
			Power 功率(kW)	Rotation Speed 转速(r/min)	Phases 相数	Voltage 电压(V)	Frequency 频率(Hz)					
WBH-00501DF	0.5	6.9/2.3	0.8/0.27	2890/980	3	200-460	50/60	1	φ 6.3	0.625	47	0.81
WBH-01001DF	1	6.9/2.3	1.8/0.6	2890/980	3	200-460	50/60	1	φ 7.1	1.25	61	1.1
WBH-01002DF	1	3.5/1.2	0.8/0.27	2890/980	3	200-460	50/60	2	φ 6.3	1.25	52	1.62
WBH-01501DF	1.5	8.9/2.9	3.0/1.0	2890/980	3	200-460	50/60	1	φ 10.0	1.875	108	2.3
WBH-02001DF	2	6.8/2.3	3.0/1.0	2890/980	3	200-460	50/60	1	φ 10.0	2.5	115	2.3
WBH-02002DF	2	3.3/1.1	1.8/0.6	2890/980	3	200-460	50/60	2	φ 7.1	2.5	73	2.2
WBH-02501DF	2.5	5.4/1.8	3.0/1.0	2890/980	3	200-460	50/60	1	φ 11.2	3.125	116	2.8
WBH-03001DF	3	5.4/1.8	3.0/1.0	2890/980	3	200-460	50/60	1	φ 11.2	3.75	122	2.8
WBH-03002DF	3	4.5/1.5	3.0/1.0	2890/980	3	200-460	50/60	2	φ 10.0	3.75	131	4.7
WBH-03003DF	3	2.4/0.8	1.8/0.6	2890/980	3	200-460	50/60	3	φ 7.1	3.75	55	3.5
WBH-05002DF	5	2.7/0.9	3.0/1.0	2890/980	3	200-460	50/60	2	φ 11.2	6.25	151	5.6
WBH-07503DF	7.5	1.8/0.6	3.0/1.0	2890/980	3	200-460	50/60	3	φ 11.2	9.4	266	8.4
WBH-10004DF	10	2.7/0.9	3.0x2/1.0x2	2890/980	3	200-460	50/60	4	φ 11.2	12.5	300	11

Size Specification 尺寸规格表

Type 型号	H	A	B	D	E	I	J	K	L	M	N
WBH-00501DF	550	545	260	280	160	φ 35	28	φ 35	25	17	17
WBH-01001DF	650	582	280	300	176	φ 40	31	φ 40	31	22	22
WBH-01002DF	670	545	260	280	205	φ 40	31	φ 40	31	22	22
WBH-01501DF	800	670	313	430	265	φ 47	40	φ 47	38	30	30
WBH-02001DF	800	670	313	430	265	φ 47	40	φ 47	38	30	30
WBH-02002DF	835	582	280	300	236	φ 47	38	φ 47	38	30	30
WBH-02501DF	845	670	313	430	265	φ 58	47	φ 58	47	36	36
WBH-03001DF	845	670	313	430	265	φ 58	47	φ 58	47	36	36
WBH-03002DF	950	670	313	430	320	φ 58	47	φ 58	47	36	36
WBH-03003DF	960	582	280	350	205	φ 58	47	φ 58	47	36	36
WBH-05002DF	1030	670	313	430	325	φ 60	48	φ 60	48	43	43
WBH-07503DF	1200	675	313	505	320	φ 54	φ 31	φ 85	80	85	55
WBH-10004DF	1400	685	352	/	890	φ 85	80	φ 85	80	104	55

双速 Dual Speed

双速 Dual Speed

300Kg–10Ton

电动运行式环链电动葫芦

Motorized Trolley Type Electric Chain Hoist

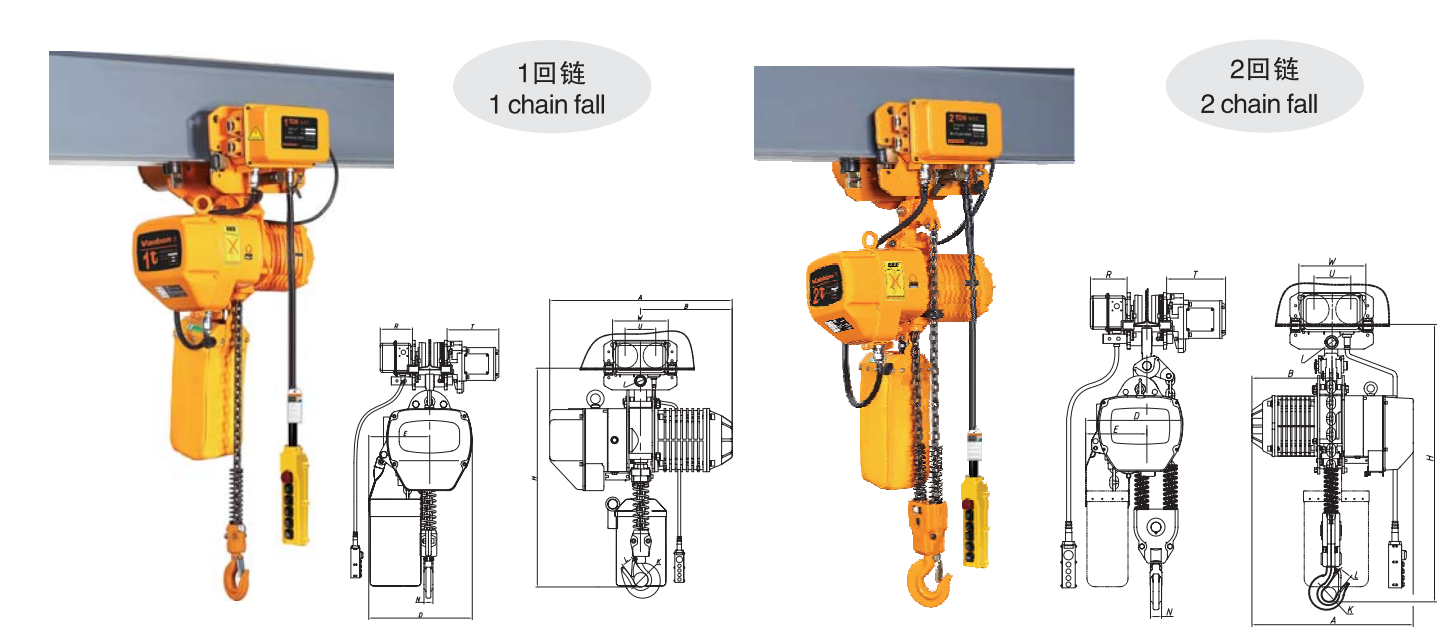

Technical Parameters 技术参数

Type 型号	Capacity 额定起重量(t)	Lifting Speed 起升速度 (m/min)	起升电机 Lifting Motor					运行电机 Operation Motor						Chain Falls 链条 回数	Chain Spec 链条 规格	Test Load 试验 载荷 (t)	I-Beam 工字 钢梁 (mm)	Weight 净重 (Kg)	Weight Added with 1m Higher 扬程每增加 1m 应加重量(Kg)
			Power 功率 (kW)	Rotation Speed 转速(r/min)	Phases 相数	Voltage 电压(V)	Frequency 频率(Hz)	Power 功率 (KW)	Rotation Speed 转速(r/min)	Operation Speed 运行速度 (m/min)	Phases 相数	Voltage 电压(V)	Frequency 频率(Hz)						
WBH-00301SE	0.3	7.1	0.75	1440	3	200-460	50/60	0.75	1440	12.2	3	200-460	50/60	1	φ 6.1	0.375	60-190	40	0.61
WBH-00501SE	0.5	6.8	0.75	1440	3	200-460	50/60	0.4	1440	11/21	3	200-460	50/60	1	φ 6.3	0.625	60-190	89	0.81
WBH-01001SE	1	6.6	1.5	1440	3	200-460	50/60	0.4	1440	11/21	3	200-460	50/60	1	φ 7.1	1.25	60-190	103	1.1
WBH-01002SE	1	3.4	0.75	1440	3	200-460	50/60	0.4	1440	11/21	3	200-460	50/60	2	φ 6.3	1.25	60-190	101	1.62
WBH-01501SE	1.5	8.8	3.0	1440	3	200-460	50/60	0.4	1440	11/21	3	200-460	50/60	1	φ 10.0	1.875	82-228	157	2.3
WBH-02001SE	2	6.6	3.0	1440	3	200-460	50/60	0.4	1440	11/21	3	200-460	50/60	1	φ 10.0	2.5	82-228	164	2.3
WBH-02002SE	2	3.3	1.5	1440	3	200-460	50/60	0.4	1440	11/21	3	200-460	50/60	2	φ 7.1	2.5	82-228	122	2.2
WBH-02501SE	2.5	5.4	3.0	1440	3	200-460	50/60	0.75	1440	11/21	3	200-460	50/60	1	φ 11.2	3.125	82-228	177	2.8
WBH-03001SE	3	5.4	3.0	1440	3	200-460	50/60	0.75	1440	11/21	3	200-460	50/60	1	φ 11.2	3.75	82-228	183	2.8
WBH-03002SE	3	4.4	3.0	1440	3	200-460	50/60	0.75	1440	11/21	3	200-460	50/60	2	φ 10.0	3.75	82-228	192	4.7
WBH-03003SE	3	2.2	1.5	1440	3	200-460	50/60	0.75	1440	11/21	3	200-460	50/60	3	φ 7.1	3.75	82-228	146	3.5
WBH-05002SE	5	2.7	3.0	1440	3	200-460	50/60	0.75	1440	11/21	3	200-460	50/60	2	φ 11.2	6.25	100-256	234	5.6
WBH-07503SE	7.5	1.8	3.0	1440	3	200-460	50/60	0.75	1440	11/21	3	200-460	50/60	3	φ 11.2	9.4	100-256	266	8.4
WBH-10004SE	10	2.7	3.0X2	1440	3	200-460	50/60	0.75	1440	11/21	3	200-460	50/60	4	φ 11.2	12.5	110-294	440	11

Size Specification 尺寸规格表

Type 型号	H	A	B	D	E	I	K	L	N	W	U	R	T
WBH-00301SE	630	415	168	260	150	φ 34	φ 34	23	15	191	99	159	142
WBH-00501SE	630	460	230	280	160	φ 35	φ 35	25	17	206	111	142	231
WBH-01001SE	650	520	260	300	176	φ 40	φ 40	32	24	206	111	142	231
WBH-01002SE	695	460	230	280	205	φ 41	φ 40	31	24	206	111	142	231
WBH-01501SE	770	615	295	430	265	φ 47	φ 47	40	30	237	127	142	231
WBH-02001SE	770	615	295	430	265	φ 47	φ 47	40	30	237	127	142	231
WBH-02002SE	815	520	260	300	236	φ 36	φ 47	38	30	237	127	142	231
WBH-02501SE	830	615	295	430	265	φ 58	φ 58	48	36	265	140	142	231
WBH-03001SE	830	615	295	430	265	φ 58	φ 58	48	36	265	140	142	231
WBH-03002SE	930	615	295	430	320	φ 43	φ 58	47	36	265	140	142	231
WBH-03003SE	940	520	260	350	205	φ 43	φ 58	47	36	265	140	142	231
WBH-05002SE	1015	615	295	430	325	φ 54	φ 60	48	43	296	156	142	231
WBH-07503SE	1200	615	295	505	320	φ 54	φ 85	80	55	295	156	142	231
WBH-10004SE	1190	630	315	/	890	φ 70	φ 85	80	55	366	191	142	231

单速 Single Speed

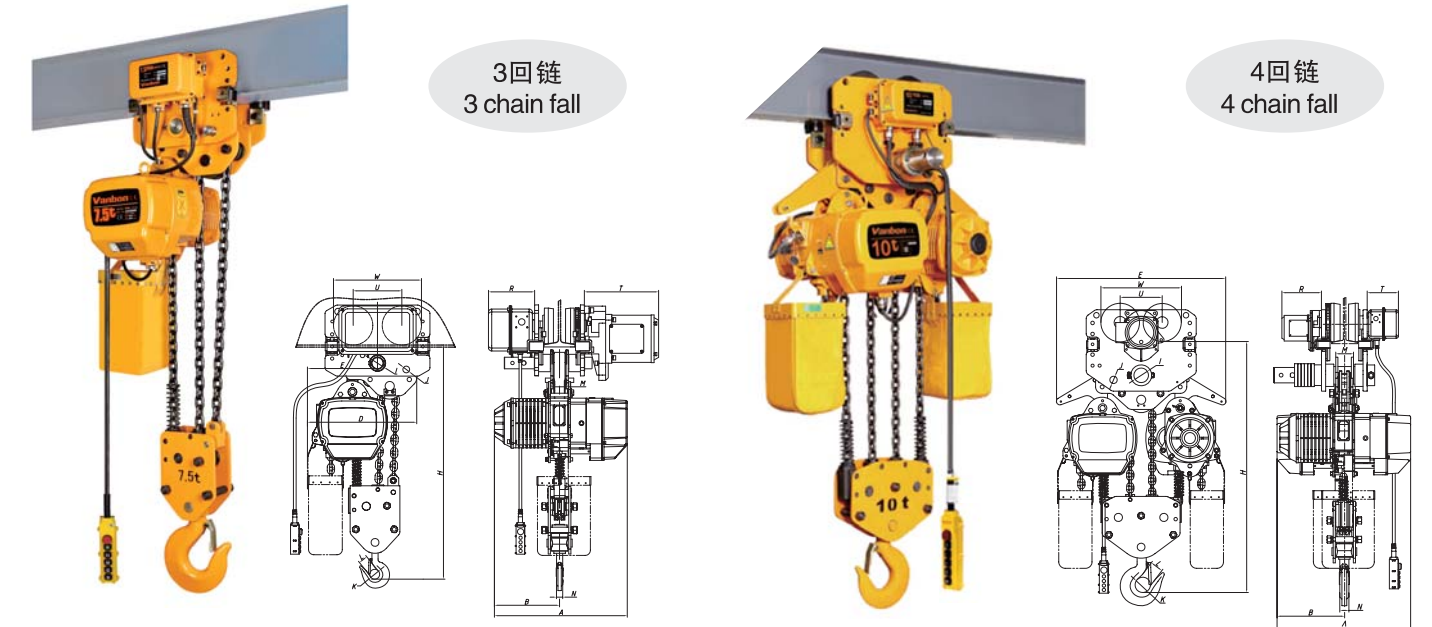

Technical Parameters 技术参数

Type 型号	Capacity 额定起重量(t)	Lifting Speed 起升速度 (m/min)	起升电机 Lifting Motor					运行电机 Operation Motor						Chain Falls 链条 回数	Chain Spec 链条 规格	Test Load 试验 载荷 (t)	I-Beam 工字 钢梁 (mm)	Weight 净重 (Kg)	Weight Added with 1m Higher 扬程每增加 1m 应加重量(Kg)
			Power 功率 (kW)	Rotation Speed 转速(r/min)	Phases 相 数	Voltage 电压(V)	Frequency 频率(Hz)	Power 功率	Rotation Speed 转速(r/min)	Operation Speed 运行速度	Phases 相 数	Voltage 电压(V)	Frequency 频率(Hz)						
WBH-00501DE	0.5	6.9/2.3	0.8/0.27	2890/980	3	200-460	50/60	0.4	1440	11/21	3	200-460	50/60	1	φ 6.3	0.625	60-190	89	0.81
WBH-01001DE	1	6.9/2.3	1.8/0.6	2890/980	3	200-460	50/60	0.4	1440	11/21	3	200-460	50/60	1	φ 7.1	1.25	60-190	116	1.1
WBH-01002DE	1	3.5/1.2	0.8/0.27	2890/980	3	200-460	50/60	0.4	1440	11/21	3	200-460	50/60	2	φ 6.3	1.25	60-190	101	1.62
WBH-01501DE	1.5	8.9/2.9	3.0/1.0	2890/980	3	200-460	50/60	0.4	1440	11/21	3	200-460	50/60	1	φ 10.0	1.875	82-228	193	2.3
WBH-02001DE	2	6.8/2.3	3.0/1.0	2890/980	3	200-460	50/60	0.4	1440	11/21	3	200-460	50/60	1	φ 10.0	2.5	82-228	199	2.3
WBH-02002DE	2	3.3/1.1	1.8/0.6	2890/980	3	200-460	50/60	0.4	1440	11/21	3	200-460	50/60	2	φ 7.1	2.5	82-228	135	2.2
WBH-02501DE	2.5	5.4/1.8	3.0/1.0	2890/980	3	200-460	50/60	0.75	1440	11/21	3	200-460	50/60	1	φ 11.2	3.125	82-228	209	2.8
WBH-03001DE	3	5.4/1.8	3.0/1.0	2890/980	3	200-460	50/60	0.75	1440	11/21	3	200-460	50/60	1	φ 11.2	3.75	82-228	220	2.8
WBH-03002DE	3	4.5/1.5	3.0/1.0	2890/980	3	200-460	50/60	0.75	1440	11/21	3	200-460	50/60	2	φ 10.0	3.75	82-228	229	4.7
WBH-03003DE	3	2.4/0.8	1.8/0.6	2890/980	3	200-460	50/60	0.75	1440	11/21	3	200-460	50/60	3	φ 7.1	3.75	82-228	163	3.5
WBH-05002DE	5	2.7/0.9	3.0/1.0	2890/980	3	200-460	50/60	0.75	1440	11/21	3	200-460	50/60	2	φ 11.2	6.25	100-256	267	5.6
WBH-07503DE	7.5	1.8/0.6	3.0/1.0	2890/980	3	200-460	50/60	0.75	1440	11/21	3	200-460	50/60	3	φ 11.2	9.4	100-256	305	8.4
WBH-10004DE	10	2.7/0.9	3.0x2/1.0x2	2890/980	3	200-460	50/60	0.75	1440	11/21	3	200-460	50/60	4	φ 11.2	12.5	110-294	520	11

双速 Dual Speed

Size Specification 尺寸规格表

Type 型号	H	A	B	D	E	I	K	L	N	W	U	R	T
WBH-00501DE	630	545	260	280	160	φ 35	φ 35	25	17	206	111	142	231
WBH-01001DE	650	582	280	300	176	φ 40	φ 40	32	24	206	111	142	231
WBH-01002DE	695	545	260	280	205	φ 41	φ 40	31	24	206	111	142	231
WBH-01501DE	770	670	313	430	265	φ 47	φ 47	40	30	237	127	142	231
WBH-02001DE	770	670	313	430	265	φ 47	φ 47	40	30	237	127	142	231
WBH-02002DE	815	582	280	300	236	φ 36	φ 47	38	30	237	127	142	231
WBH-02501DE	830	670	313	430	265	φ 58	φ 58	47	36	265	140	142	231
WBH-03001DE	830	670	313	430	265	φ 58	φ 58	47	36	265	140	142	231
WBH-03002DE	930	670	313	430	320	φ 43	φ 58	47	36	265	140	142	231
WBH-03003DE	940	582	280	350	205	φ 43	φ 58	47	36	265	140	142	231
WBH-05002DE	1015	670	313	430	325	φ 54	φ 60	48	43	296	156	142	231
WBH-07503DE	1200	670	313	505	320	φ 54	φ 85	80	55	295	156	142	231
WBH-10004DE	1190	685	352	/	890	φ 70	φ 85	80	55	366	191	142	231

双速 Dual Speed

300Kg–5Ton

手动小车运行式环链电动葫芦
Manual Trolley Type Electric Chain Hoist

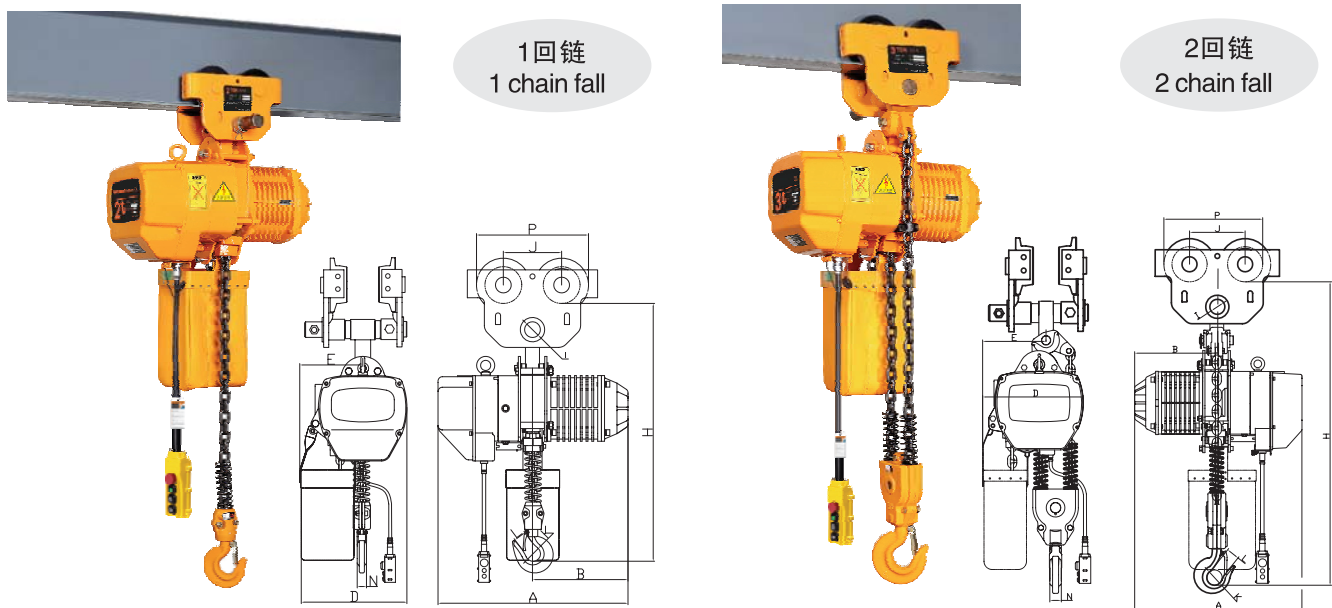

Technical Parameters 技术参数

Type 型号	Capacity 额定起重量(t)	Lifting Speed 起升速度 (m/min)	起升电机 Lifting Motor					Chain Falls 链条回数	Chain Spec 链条规格	Test Load 试验载荷(t)	I-Beam 工字钢梁 (mm)	Weight 净重 (Kg)	Weight Added with 1m Higher 扬程每增加1m 应加重(Kg)
			Power 功率(kW)	Rotation Speed 转速(r/min)	Phases 相数	Voltage 电压(V)	Frequency 频率(Hz)						
WBH-00301SM	0.3	7.1	0.75	1440	3	200-460	50/60	1	φ 6.1	0.375	52-100	40	0.61
WBH-00501SM	0.5	6.8	0.75	1440	3	200-460	50/60	1	φ 6.3	0.625	52-100	53	0.81
WBH-01001SM	1	6.6	1.5	1440	3	200-460	50/60	1	φ 7.1	1.25	52-120	67	1.1
WBH-01002SM	1	3.4	0.75	1440	3	200-460	50/60	2	φ 6.3	1.25	52-120	67	1.1
WBH-01501SM	1.5	8.8	3.0	1440	3	200-460	50/60	1	φ 10.0	1.875	60-105	118	2.3
WBH-02001SM	2	6.6	3.0	1440	3	200-460	50/60	1	φ 10.0	2.5	60-105	125	2.3
WBH-02002SM	2	3.3	3.0	1440	3	200-460	50/60	2	φ 7.1	2.5	60-105	83	2.3
WBH-02501SM	2.5	5.4	3.0	1440	3	200-460	50/60	1	φ 11.2	3.125	60-185	132	2.8
WBH-03001SM	3	5.4	3.0	1440	3	200-460	50/60	1	φ 11.2	3.75	60-185	138	2.8
WBH-03002SM	3	4.4	3.0	1440	3	200-460	50/60	2	φ 10.0	3.75	60-185	147	4.7
WBH-05002SM	5	2.7	3.0	1440	3	200-460	50/60	2	φ 11.2	3.75	82-180	181	5.6

Size Specification 尺寸规格表

Type 型号	H	A	B	D	F	K	L	N	I	J	P
WBH-00301SM	580	460	230	280	160	φ 35	28	17	φ 28	91	163
WBH-00501SM	580	460	230	280	160	φ 35	28	17	φ 28	91	163
WBH-01001SM	635	520	260	300	176	φ 40	31	22	φ 26	90	164
WBH-01002SM	670	460	230	280	205	φ 40	31	22	φ 26	90	164
WBH-01501SM	764	615	295	430	265	φ 47	38	30	φ 31	115	221
WBH-02001SM	764	615	295	430	265	φ 47	38	30	φ 31	115	221
WBH-02002SM	800	520	260	300	236	φ 47	38	30	φ 31	115	221
WBH-02501SM	854	615	295	430	265	φ 58	47	36	φ 36	138	265
WBH-03001SM	854	615	295	430	265	φ 58	47	36	φ 36	138	265
WBH-03002SM	960	615	295	430	320	φ 58	47	36	φ 36	138	265
WBH-03003SM	968	520	260	350	205	φ 58	47	36	φ 36	138	265
WBH-05002SM	1007	615	295	430	325	φ 60	48	43	φ 43	157	304

15Ton–35Ton

固定式环链电动葫芦
Suspension Type Electric Chain Hoist

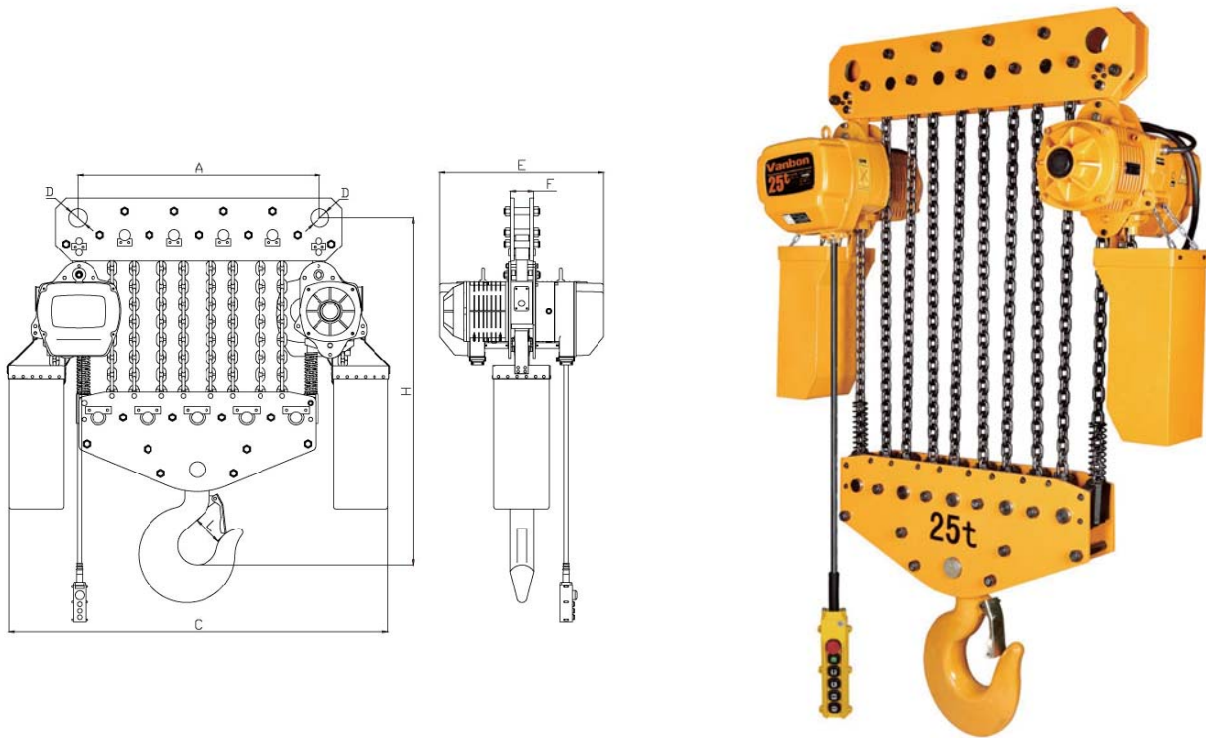

Technical Parameters 技术参数

Type 型号	Capacity 额定起重量(t)	Lifting Speed 起升速度 (m/min)	起升电机 Lifting Motor					Chain Falls 链条回数	Chain Spec 链条规格	Test Load 试验载荷(t)	Weight 净重 (Kg)	Weight Added with 1m Higher 扬程每增加1m 应加重(Kg)
			Power 功率(kW)	Rotation Speed 转速(r/min)	Phases 相数	Voltage 电压(V)	Frequency 频率(Hz)					
WBH-15006SF	15	1.8	3.0X2	1440	3	200-460	50/60	6	φ11.2	18.75	400	17
WBH-20008SF	20	1.4	3.0X2	1440	3	200-460	50/60	8	φ11.2	25	480	22
WBH-25010SF	25	1.1	3.0X2	1440	3	200-460	50/60	10	φ11.2	31.25	540	28
WBH-30012SF	30	0.9	3.0X2	1440	3	200-460	50/60	12	φ11.2	37.5	1050	31
WBH-35016SF	35	0.7	3.0X2	1440	3	200-460	50/60	16	φ11.2	43.75	1250	44.8

WBH-15006DF	15	1.8/0.6	3.0X2/1.0x2	2880/960	3	200-460	50/60	6	φ11.2	18.75	480	17
WBH-20008DF	20	1.5/0.5	3.0X2/1.0x2	2880/960	3	200-460	50/60	8	φ11.2	25	560	22
WBH-25010DF	25	1.2/0.4	3.0X2/1.0x2	2880/960	3	200-460	50/60	10	φ11.2	31.25	620	28
WBH-30012DF	30	1.0/0.3	3.0X2/1.0x2	2880/960	3	200-460	50/60	12	φ11.2	37.5	1100	31
WBH-35016DF	35	0.7/0.25	3.0X2/1.0x2	2880/960	3	200-460	50/60	16	φ11.2	43.75	1310	44.8

Size Specification 尺寸规格表

Type 型号	H	A	B	E	I	J	K	L	Q	M	N
WBH-15006SF	1310	630	315	535	φ 54	φ 54	φ 120	96	560	88	78
WBH-20008SF	1470	630	315	630	φ 70	φ 70	φ 150	115	740	88	98
WBH-25010SF	1580	630	315	725	φ 70	φ 70	φ 150	115	830	88	95
WBH-30012SF	1640	740	315	1300	φ 100	φ 100	φ 140	95	440	217	130
WBH-35016SF	1790	740	315	1500	φ 100	φ 100	φ 200	140	440	217	150

WBH-15006DF	1310	685	352	535	φ 54	φ 54	φ 120	96	560	88	78
WBH-20008DF	1470	685	352	630	φ 70	φ 70	φ 150	115	740	88	98
WBH-25010DF	1580	685	352	725	φ 70	φ 70	φ 150	115	740	88	98
WBH-30012DF	1640	795	352	1300	φ 70	φ 70	φ 150	115	830	88	95
WBH-35016DF	1790	795	352	1500	φ 100	φ 100	φ 200	140	440	217	150

15Ton-25Ton 电动小车运行式环链电动葫芦 Motorized Trolley Type Electric Chain Hoist

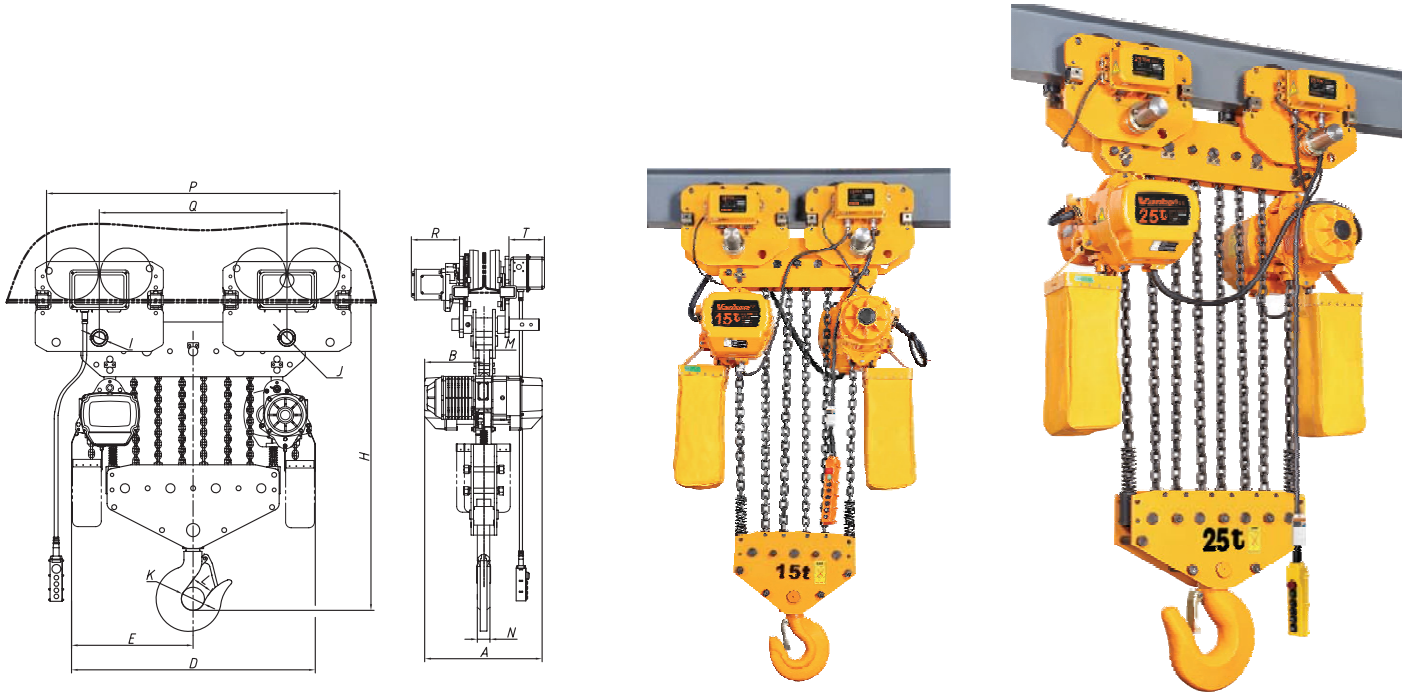

Technical Parameters 技术参数

Type 型号	Capacity 额定起重量(t)	Lifting Speed 起升速度 (m/min)	起升电机 Lifting Motor				运行电机 Operation Motor				Chain Falls 链条 回数	Chain Spec 链条 规格	Test Load 试验 载荷 (t)	I-Beam 工字 钢梁 (mm)	Weight 净重 (Kg)	Weight Added with 1m Higher 扬程每增加1m 应加重量(Kg)
			Power 功率(kW)	Rotation Speed 转速 (r/min)	Phases 相数	Voltage 电压(V)	Frequency 频率(Hz)	Power 功率(kW)	Rotation Speed 转速 (r/min)	Operation Speed 运行速度 (m/min)	Phases 相数	Voltage 电压(V)	Frequency 频率(Hz)			
WBH-15006SE	15	1.8	3.0x2	1440	3	200-460	50/60	0.75x2	1440	11/21	3	200-460	50/60	6	φ 11.2	18.75 150-220 400
WBH-20008SE	20	1.4	3.0x2	1440	3	200-460	50/60	0.75x2	1440	11/21	3	200-460	50/60	8	φ 11.2	25 150-220 480
WBH-25010SE	25	1.1	3.0x2	1440	3	200-460	50/60	0.75x2	1440	11/21	3	200-460	50/60	10	φ 11.2	31.25 150-220 540
WBH-15006DE	15	1.8/0.6	3.0x2/1.0x2	2890/980	3	200-460	50/60	0.75x2	2890/980	11/21	3	200-460	50/60	6	φ 11.2	18.75 150-220 480
WBH-20008DE	20	1.5/0.6	3.0x2/1.0x2	2890/980	3	200-460	50/60	0.75x2	2890/980	11/21	3	200-460	50/60	8	φ 11.2	25 150-220 560
WBH-25010DE	25	1.2/0.4	3.0x2/1.0x2	2890/980	3	200-460	50/60	0.75x2	2890/980	11/21	3	200-460	50/60	10	φ 11.2	31.25 150-220 620

单速 Single Speed / 双速 Dual Speed

Size Specification 尺寸规格表

Type 型号	H	A	B	D	E	I	J	K	L	M	N	P	Q	R	T
WBH-15006SE	1310	630	315	1070	535	φ 54	φ 54	φ 120	96	88	78	926	560	142	231
WBH-20008SE	1470	630	315	1260	630	φ 70	φ 70	φ 150	115	88	98	1106	740	142	231
WBH-25010SE	1580	630	315	1260	725	φ 70	φ 70	φ 150	115	88	95	1280	830	142	231
WBH-15006DE	1310	685	352	1070	535	φ 54	φ 54	φ 120	96	88	78	926	560	142	231
WBH-20008DE	1470	685	352	1260	630	φ 70	φ 70	φ 150	115	88	98	1106	740	142	231
WBH-25010DE	1580	685	352	1260	725	φ 70	φ 70	φ 150	115	88	95	1280	830	142	231

单速 Single Speed / 双速 Dual Speed

100kg-400kg 挂钩式环链电动葫芦 Hook Suspension Type Mini Electric Chain Hoist

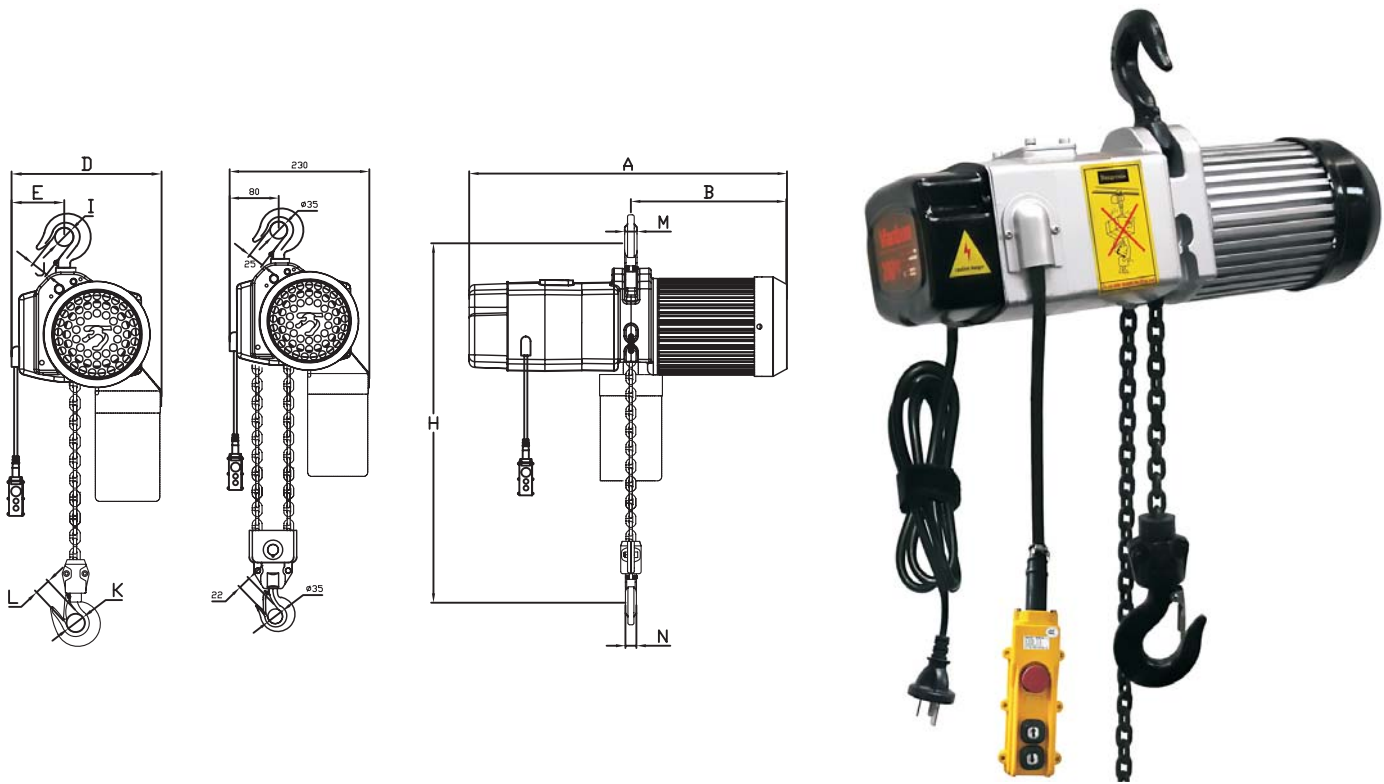

适用范围：本产品广泛用于工厂、仓库、料场等不同场合吊运货物，禁止在易燃、易爆腐蚀性介质环境中使用。

Usage: Fit for various Construction Workplaces, Civil Engineering, General Factories, Plumbing, Coating Scaffolding, Warehousing, Building, Domestics, Farming and Fishing Industries, Stores and Even More.

Technical Parameters 技术参数

Type 型号	Capacity 额定起重量(t)	Lifting Speed 起升速度 (m/min)	起升电机 Lifting Motor					Chain Falls 链条 回数	Chain Spec 链条 规格	Test Load 试验 载荷 (t)	Weight 净重 (Kg)	Weight Added with 1m Higher 扬程每增加1m 应加重量(Kg)
			Power 功率(kW)	Rotation Speed 转速 (r/min)	Phases 相数	Voltage 电压(V)	Frequency 频率(Hz)					
WBH-00101SF	0.1	8	0.37	1440	1	220	50/60	1	φ 5.0	0.125	18	0.5
WBH-00202SF	0.2	4	0.37	1440	1	220	50/60	2	φ 5.0	0.24	22	1
WBH-00201SF	0.2	8	0.37	1440	3	200-460	50/60	1	φ 5.0	0.24	18	0.5
WBH-00402SF	0.4	4	0.37	1440	3	200-460	50/60	2	φ 5.0	0.48	22	1

单速 Single Speed

Size Specification 尺寸规格表

Type 型号	H	A	B	E	I	J	K	L	Q	M	N
WBH-00101SF	335	450	225	80	φ 35	φ 25	φ 35	22	/	20	17
WBH-00202SF	395	450	225	80	φ 35	φ 25	φ 35	22	/	20	17
WBH-00201SF	335	450	225	80	φ 35	φ 25	φ 35	22	/	20	17
WBH-00402SF	395	450	225	80	φ 35	φ 25	φ 35	22	/	20	17

单速 Single Speed

500Kg-10Ton

低净空型环链电动葫芦

Low – Headroom Type Electric Chain Hoist

Product Features:

Vanbon Ultra Low Headroom Electric Chain Hoists are designed for those applications where space is limited. The units provide smooth, quiet trouble free operation in a variety of Class III applications. The units are equipped with the following features:

- FEC G80 ultra heat-treated alloy steel chain which is suitable for rain, sea water and chemical environments.
- Choices of lug mounted push/pull, hand geared or motorized trolley drives geared limit switches for both upper and lower hook travel.
- Standard voltage is 200-460 Volt, 3phase.
- Capacities from 0.5 ton through 10 tons
- Sturdy steel construction
- Direct acting motor brakes

Vanbon 低净空环链电动葫芦专为操作空间受限制而设计的机种，可达扬程最大化，并争取较大的操作难度。

具备以下特点：

- 使用FEC G80超热处理合金钢进口链条，适用于雨水，海水以及化学环境中。
- 固定式以及电动运行式，供选择；
- 标配限位开关，急停按钮，起吊更安全；
- 电压区间：200–460V；
- 载重为0.5–10吨。

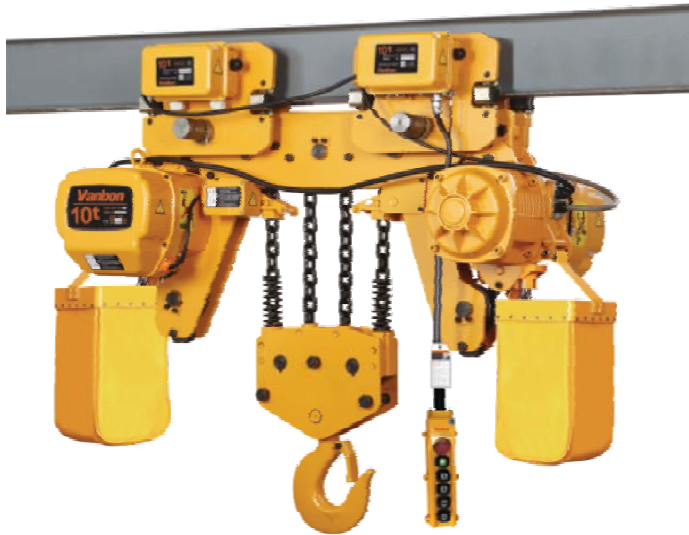
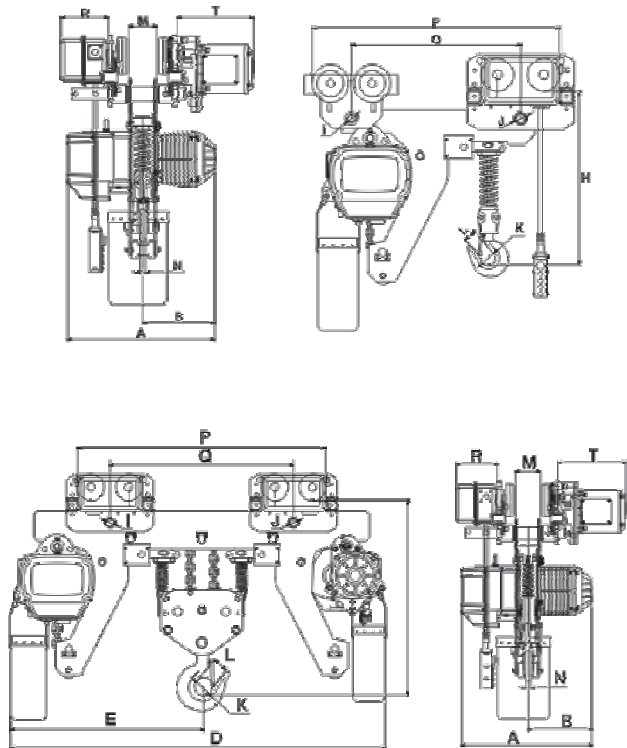

Technical Parameters 技术参数

单速 Single Speed

Type 型号	Capacity 额定起重量(t)	Lifting Speed 起升速度 (m/min)	起升电机 Lifting Motor					运行电机 Operation Motor					Chain Falls 链条 回数	Chain Spec 链条 规格	Test Load 试验 载荷 (t)	I-Beam 工字 钢梁 (mm)	Weight Added with 1m Higher 扬程每增加1m 应加重量(kg)	
			Power 功率(kW)	Rotation Speed 转速 (r/min)	Phases 相数	Voltage 电压(V)	Frequency 频率(Hz)	Power 功率(kW)	Rotation Speed 转速 (r/min)	Operation Speed 运行速度 (m/min)	Phases 相数	Voltage 电压(V)						Frequency 频率(Hz)
WBH-00501SL	0.5	6.8	0.75	1440	3	200-460	50/60	0.4	1440	11/21	3	200-460	50/60	1	φ 6.3	0.625	60-190	0.81
WBH-01001SL	1	6.6	1.5	1440	3	200-460	50/60	0.4	1440	11/21	3	200-460	50/60	1	φ 7.1	1.25	60-190	1.1
WBH-01501SL	1.5	8.8	3.0	1440	3	200-460	50/60	0.4	1440	11/21	3	200-460	50/60	1	φ 10.0	1.875	82-228	2.3
WBH-02001SL	2	6.6	3.0	1440	3	200-460	50/60	0.4	1440	11/21	3	200-460	50/60	1	φ 10.0	2.5	82-228	2.3
WBH-02002SL	2	3.3	1.5	1440	3	200-460	50/60	0.4	1440	11/21	3	200-460	50/60	2	φ 7.1	2.5	82-228	2.2
WBH-02501SL	2.5	5.4	3.0	1440	3	200-460	50/60	0.75	1440	11/21	3	200-460	50/60	1	φ 11.2	3.125	82-228	2.8
WBH-03001SL	3	5.4	3.0	1440	3	200-460	50/60	0.75	1440	11/21	3	200-460	50/60	1	φ 11.2	3.75	82-228	2.8
WBH-03002SL	3	4.4	3.0	1440	3	200-460	50/60	0.75	1440	11/21	3	200-460	50/60	2	φ 10.0	3.75	82-228	4.7
WBH-05002SL	5	2.7	3.0	1440	3	200-460	50/60	0.75	1440	11/21	3	200-460	50/60	2	φ 11.2	6.25	100-256	5.6
WBH-07503SL	7.5	1.8	3.0	1440	3	200-460	50/60	0.75	1440	11/21	3	200-460	50/60	3	φ 11.2	9.4	100-256	8.4
WBH-10004SL	10	2.7	3.0x2	1440	3	200-460	50/60	0.75	1440	11/21	3	200-460	50/60	4	φ 11.2	12.5	120-294	11

Type 型号	H	A	B	D	E	I	J	K	L	M	N	P	Q	R	T
WBH-00501SL	440	460	230	/	/	φ 31	φ 31	φ 35	25	52	17	585	400	142	231
WBH-01001SL	480	520	260	/	/	φ 31	φ 31	φ 40	31	56	22	630	445	142	231
WBH-01501SL	570	615	295	/	/	φ 31	φ 36	φ 47	38	66	30	720	505	142	231
WBH-02001SL	570	615	295	/	/	φ 31	φ 36	φ 47	38	66	30	720	505	142	231
WBH-02002SL	535	520	260	/	/	φ 31	φ 36	φ 47	38	56	30	665	445	142	231
WBH-02501SL	640	615	295	/	/	φ 36	φ 43	φ 58	47	73	36	775	526	142	231
WBH-03001SL	640	615	295	/	/	φ 36	φ 43	φ 58	47	73	36	775	526	142	231
WBH-03002SL	685	615	295	/	/	φ 36	φ 43	φ 58	47	66	36	750	503	142	231
WBH-05002SL	740	615	295	/	/	φ 43	φ 54	φ 60	48	73	43	825	541	142	231
WBH-07503SL	890	615	295	/	/	φ 43	φ 54	φ 85	80	73	55	1020	730	142	231
WBH-10004SL	880	630	315	1640	820	φ 54	φ 54	φ 85	80	85	55	926	630	142	231

Technical Parameters 技术参数

双速 Dual Speed

Type 型号	Capacity 额定起重量(t)	Lifting Speed 起升速度 (m/min)	起升电机 Lifting Motor					运行电机 Operation Motor					Chain Falls 链条 回数	Chain Spec 链条 规格	Test Load 试验 载荷 (t)	I-Beam 工字 钢梁 (mm)	Weight Added with 1m Higher 扬程每增加1m 应加重量(Kg)	
			Power 功率(kW)	Rotation Speed 转速 (r/min)	Phases 相数	Voltage 电压(V)	Frequency 频率(Hz)	Power 功率(kW)	Rotation Speed 转速 (r/min)	Operation Speed 运行速度	Phases 相数	Voltage 电压(V)						Frequency 频率(Hz)
WBH-00501DL	0.5	6.9/2.3	0.8/0.3	2890/980	3	200-460	50/60	0.4	1440	11/21	3	200-460	50/60	1	φ 6.3	0.625	60-190	0.81
WBH-01001DL	1	6.9/2.3	1.8/0.6	2890/980	3	200-460	50/60	0.4	1440	11/21	3	200-460	50/60	1	φ 7.1	1.25	60-190	1.1
WBH-01501DL	1.5	9.0/3.0	3.0/1.0	2890/980	3	200-460	50/60	0.4	1440	11/21	3	200-460	50/60	1	φ 10.0	1.875	82-228	2.3
WBH-02001DL	2	6.9/2.3	3.0/1.0	2890/980	3	200-460	50/60	0.4	1440	11/21	3	200-460	50/60	1	φ 10.0	2.5	82-228	2.3
WBH-02002DL	2	3.4/1.1	1.8/0.6	2890/980	3	200-460	50/60	0.4	1440	11/21	3	200-460	50/60	2	φ 7.1	2.5	82-228	2.2
WBH-02501DL	2.5	5.4/1.8	3.0/1.0	2890/980	3	200-460	50/60	0.75	1440	11/21	3	200-460	50/60	1	φ 11.2	3.125	82-228	2.8
WBH-03001DL	3	5.4/1.8	3.0/1.0	2890/980	3	200-460	50/60	0.75	1440	11/21	3	200-460	50/60	1	φ 11.2	3.75	82-228	2.8
WBH-03002DL	3	4.5/1.5	3.0/1.0	2890/980	3	200-460	50/60	0.75	1440	11/21	3	200-460	50/60	2	φ 10.0	3.75	82-228	4.7
WBH-05002DL	5	2.7/0.9	3.0/1.0	2890/980	3	200-460	50/60	0.75	1440	11/21	3	200-460	50/60	2	φ 11.2	6.25	100-256	5.6
WBH-07503DL	7.5	1.8/0.6	3.0/1.0	2890/980	3	200-460	50/60	0.75	1440	11/21	3	200-460	50/60	3	φ 11.2	9.4	100-256	8.4
WBH-10004DL	10	2.7/0.9	3.0x2/1.0x2	2890/980	3	200-460	50/60	0.75	1440	11/21	3	200-460	50/60	4	φ 11.2	12.5	120-294	11

Type 型号	H	A	B	D	E	I	J	K	L	M	N	P	Q	R	T
WBH-00501DL	440	545	260	/	/	φ 31	φ 31	φ 35	25	52	17	585	400	142	231
WBH-01001DL	480	582	280	/	/	φ 31	φ 31	φ 40	31	56	22	630	445	142	231
WBH-01501DL	570	670	313	/	/	φ 31	φ 36	φ 47	38	66	30	720	505	142	231
WBH-02001DL	570	670	313	/	/	φ 31	φ 36	φ 47	38	66	30	720	505	142	231
WBH-02002DL	535	582	280	/	/	φ 31	φ 36	φ 47	38	56	30	665	445	142	231
WBH-02501DL	640	670	313	/	/	φ 36	φ 43	φ 58	47	73	36	775	526	142	231
WBH-03001DL	640	670	313	/	/	φ 36	φ 43	φ 58	47	73	36	775	526	142	231
WBH-03002DL	685	670	313	/	/	φ 36	φ 43	φ 58	47	66	36	750	503	142	231
WBH-05002DL	740	670	313	/	/	φ 43	φ 54	φ 60	48	73	43	825	541	142	231
WBH-07503DL	890	670	313	/	/	φ 43	φ 54	φ 85	80	73	55	1020	730	142	231
WBH-10004DL	880	670	388	1640	820	φ 54	φ 54	φ 85	80	85	55	926	630	142	231

电动小车 Motorized Trolley

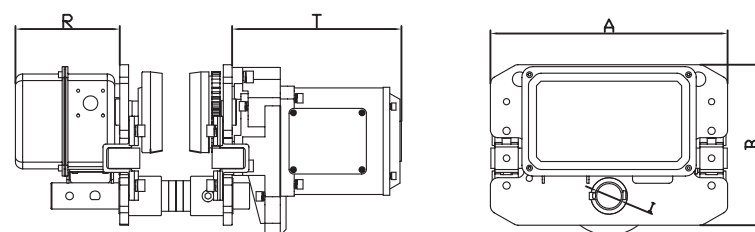

Size Specification 尺寸规格表

Type 型号	ET-003	ET-005	ET-010	ET-020	ET-030	ET-050	ET-075	ET-100
Capacity 荷重(t)	0.3	0.5	1	2	3	5	7.5	10
Unit 单位(mm)	A	315	315	315	325	340	400	500
	B	212	212	212	220	250	291	370
	R	120	142	142	142	142	142	142
	T	142	231	231	231	231	231	231
	I	φ28	φ31	φ31	φ36	φ43	φ54	φ70
Speed 速度 50Hz(m/min)	12.2	11/21	11/21	11/21	11/21	11/21	11/21	11/21
Motor 马达(kW)	0.21	0.4	0.4	0.4	0.75	0.75	0.75	0.75
Minimum Turning Radius 最小回转半径(m)	0.8	0.8	0.8	0.8	1.0	1.8	1.8	2.5
I-Beam 工字钢梁轨道(mm)	60-190	60-190	60-190	82-228	82-228	100-256	100-256	120-294

手动小车 Manual Trolley

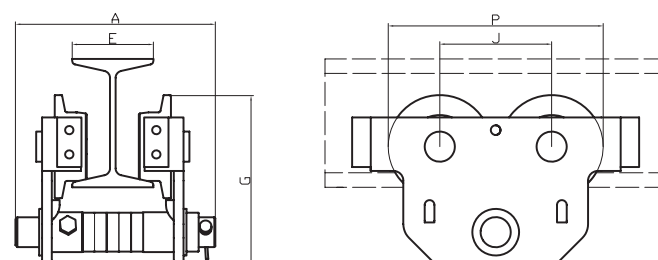

Size Specification 尺寸规格表

Type 型号	MT-003	MT-005	MT-010	MT-020	MT-030	MT-050
Capacity 荷重(t)	0.3	0.5	1	2	3	5
Unit 单位(mm)	A	460	200	200	218	275
	G	180	170	170	205	236
	J	91	115	115	138	157
	E	52-100	52-120	52-120	60-105	60-185
	P	163	221	221	265	305
Minimum Turning Radius 最小回转半径(m)	0.6	0.6	0.6	1.0	1.0	1.2

葫芦配件 Hoist Accessories

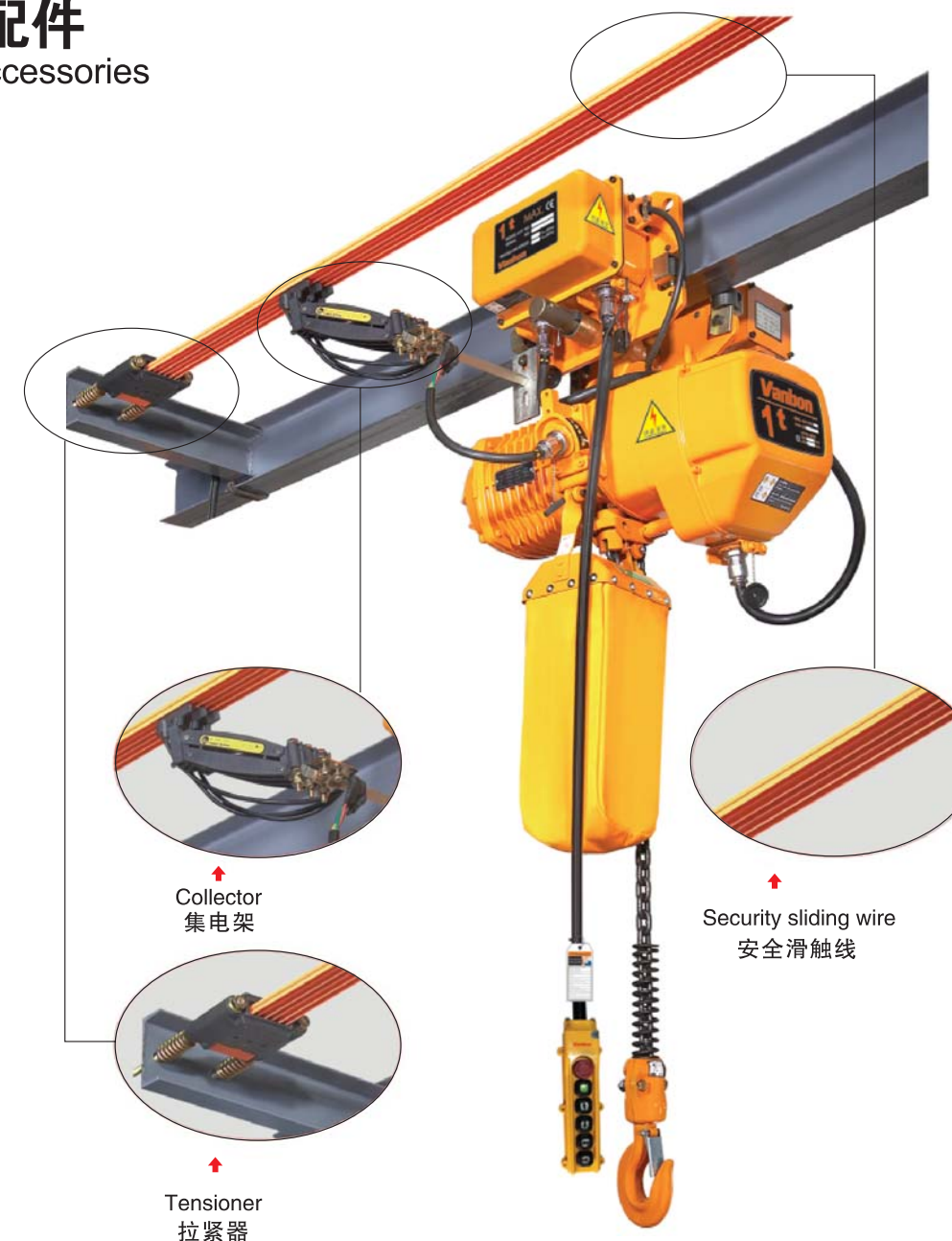

↑ Wireless remote control for single speed.
远程遥控器 (单速)



↑ Wireless remote control for dual speed
远程遥控器 (双速)



↑ Overload limiter
超载限制器



↑ Chain bag
链条袋

起重机马达
Crane Geared Motor

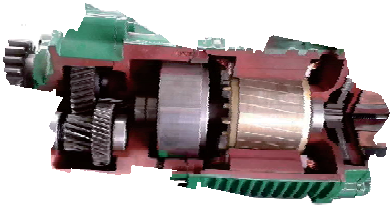
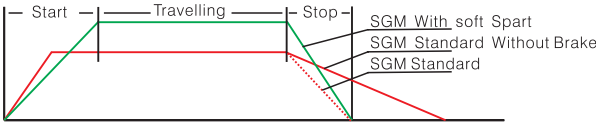

- Technology and precise gears: The steel surface of precise gears after heat treatment are ground by using ISO 6(DIN 6) or AGMA 12. The tooth profile is effectively modified through professional technology to achieve highly efficient operation.
- Shaft: Shaft is designed with the ability to accommodate bend intensity and torsion loads within the specifications. It is made with steel surface after heat treatment in order to make it operate smoothly and lastingly. The deflection of the shaft is precisely calculated and properly modified to enable the gear wheel to engage with the gear shaft while loading. Both the input and output shaft sealing areas are specifically ground and hardened to make an effective and leakage-free sealing surface between the seal's lip and the shafts.
- Rigid Housing: We carefully select the suitable housing materials to fit application requirement. For example, a fitting gear is made by accurate machining. It allows horizontal mounting to suit
- Electrical motors and brake: Electrical motors can be supplied together with the gear box, and we also offer various voltages to suit every region. Emergency stop brakes for operation are ideal. The safe brakes are used whenever a constant brake torque is in utmost operation.
- Mounting flanges: The gear box can be equipped with mounting flange for easily mounting onto the drive.
- Soft starting: The buffer helps the gear motor to start gently. It greatly reduces the wear of gears and increases the product life.
- 专业技术及精密齿轮: 齿轮钢材经热处理，表面经ISO 6(DIN 06)或AGMA 12等级研磨处理，有效修正表面齿形以达到高效运转。
- 轴心: 轴心设计经过弯曲强度与扭转负荷条件能力要求及选用表面热处理过钢材以让轴心运转顺畅。轴心上考量挠度计算及适宜修正齿轮与齿轮轴心负载下之齿轮咬合，入力与输出轴之油封处皆经硬化处理，长效耐磨油封保护避免唇部与轴心之间漏油。
- 机体: 严谨选用合适机构，箱体铸件材质。如经过精密加工机加工制作以达到精准装配齿轮，且能够在预留空间上进行水平、垂直或站立固定安装。
- 电磁马达与紧急刹车装置: 电磁马达能与齿轮箱紧密结合，紧急刹车装置可载运转中紧急停止起到保护的作用。
- 缓冲制动: 特性为软启动，可保护齿轮，较少摩擦，增加使用寿命。

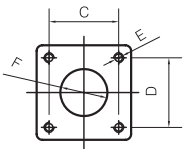
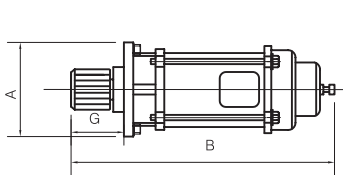

Model Number	WBM-030
A	130
B	399
C	93
D	93
E	4-φ11
F	φ65
G	108

Technical Parameters 技术参数

Model 型号	Voltage 电源供给	Power 功率 (kW)	Poles 极数	Speed 速度	Gear Ratio 转速比	Weight 净重	Output Module 输出齿模数	output gear 输出齿					
WBM-030 (No Buffer) 无缓冲	200-460V 50Hz	0.25	4P	150	10:1	11	M3	Gear/齿数	12	14	15	16	17
		0.25	6P	90	10:1	11	M3.5	Speed/速度	14.1	16.5	17.7	19	20
								Gear/齿数	10	11	12	13	14
		0.4	4P	150	10:1	11	M4	Gear/齿数	10				
								Speed/速度	16				

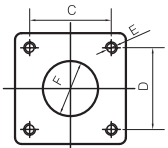
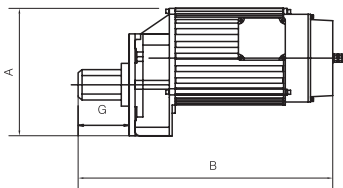

Model Number	WBM-050	WBM-100
A	210	230
B	425	453.5
C	106	115.5
D	106	115.5
E	4-φ11	4-φ13
F	φ65	φ75
G	100	100

Technical Parameters 技术参数

Model 型号	Voltage 电源供给	Power 功率 (kW)	Poles 极数	Speed 速度	Gear Ratio 转速比	Weight 净重	Output Module 输出齿模数		output gear 输出齿						
WBM-050 (No Buffer) 无缓冲	3P 200-460V 50Hz	0.4	4P	176	8. 5:1	16	M3	Gear/齿数	12	13	14	15	16	17	
									Speed/速度	17.1	18.5	20	21.5	22.8	24.3
WBM-050QX (With Buffer) 有缓冲	3P 200-460V 50Hz	0.37	6P	115	8. 5:1	16	M3.5	Gear/齿数	10	11	12	13	14	15	
									Speed/速度	16.7	18.5	20.1	21.7	23.5	25.1
		0.75	4P	176	8. 5:1	16	M4	Gear/齿数	9	10	11	12	13		
		0.6	6P	115	8. 5:1	16			Speed/速度	17.3	19.3	21.2	23.1	25	
WBM-100 (With Buffer) 有缓冲	3P 200-460V 50Hz	0.75	4P	188	7. 7:1	25	M3	Gear/齿数	13	14	15	16			
									Speed/速度	19	21	23	24.4		
		0.6	6P	123	7. 7:1	25	M3.5	Gear/齿数	10	11	12	13	14	15	
		0.4/0.13	4P	188/62	7. 7:1	25			Speed/速度	17.9	19.6	21.5	23.8	25.7	27.5
WBM-100 QX (With Buffer) 有缓冲	3P 200-460V 50Hz						M4	Gear/齿数	9	10	11	12	13	14	
		1. 1	4P	188	7. 7:1	25			Speed/速度	18.8	21	23	25.1	27.2	32.2
		0. 75	6P	123	7. 7:1	25	M5	Gear/齿数	7	8	9	10	11		
									Speed/速度	18.8	21.5	24.2	26.8	29.5	

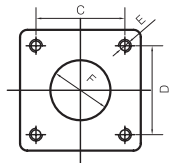
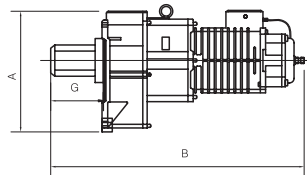
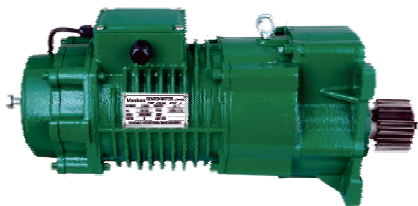

Model Number	WBM-150	WBM-200	WBM-300
A	235	370	297
B	511	717	316.6
C	126	200	152
D	149	210	201
E	4-φ13	4-φ18	4-φ16
F	φ100	φ150	φ150
G	91	124	115

Technical Parameters 技术参数

Model 型号	Voltage 电源供给	Power 功率 (kW)	Poles 极数	Speed 速度	Gear Ratio 转速比	Weight 净重	Output Module 输出齿模数		output gear 输出齿						
WBM-150 (With Buffer) 无缓冲	3P 200-460V 50Hz	1.1	4P	114	13:1	47	M3.5	Gear/齿数	15	16	18	20	22	24	
		0.75	6P	67	13:1	47		Speed/速度	16.6	17.7	19.9	22	24.3	26.5	
		0.6/0.2	4/12P	114/33	13:1	47	M4	Gear/齿数	14	15	16	17	18	20	
WBM-150QX (With Buffer) 有缓冲	3P 200-460V 50Hz	1.5	4P	114	13:1	47		M4.5	Speed/速度	17.9	19.2	20.5	21.8	23.1	25.5
		1.1	6P	67	13:1	47	Gear/齿数		12	13	14	15	16	17	
								Speed/速度	19.7	21.4	23	24.7	26.3	28	
WBM-200 (With Buffer) 有缓冲	3P 200-460V 50Hz	1.5	4P	92	16:1	66	M3	Gear/齿数	19	21	23	25	27		
		1.1	4P	92	16:1	66		Speed/速度	17	18.8	20.5	22.3	24.2		
		1.5	6P	61	16:1	66	M3.5	Gear/齿数	16	17	18	19	20	21	
		0.75/0.25	4/12P	92/30	16:1	66		Speed/速度	16.5	17.5	18.6	19.6	20.7	21.7	
							M4	Gear/齿数	13	14	15	16	17	18	
								Speed/速度	16.7	18	19.3	20.6	21.9	23.2	
WBM-200 QX (With Buffer) 有缓冲	3P 200-460V 50Hz	2.2	4P	92	16:1	66	M5	Gear/齿数	11	12	13	14	15		
		1.5	6P	61	16:1	66		Speed/速度	17.4	19	20.5	22.2	23.7		
WBM-300 (With Buffer) 有缓冲	3P 200-460V 50Hz	2.2	4P	92	16:1	82	M5	Gear/齿数	17	18	19	20	21	22	
		1.5	6P	61	16:1	82		Speed/速度	18.6	19.7	20.8	21.9	22.9	24	
		1.5/0.5	4/12P	92/30	16:1	82	M6	Gear/齿数	14	15	16	17	18		
					Speed/速度	18.8		20.1	21.4	22.8	24.1				

起重机端梁

Top Running End Trucks

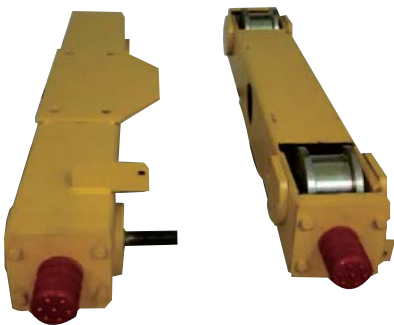

- The steel structure with built-in wheel, buffers and buffer plates.
- The material of steel wheels is S45C after heat treatment. In addition, 34CrMo4 (JIS-SCM435, AISI-4135) is available on request.
- The material of the shaft is steel afterheat treatment.
- Long life bearings which are with lubricant provide the function of anti-friction.
- The material of the bearing house is cast iron or steel.
- 行走轮含钢板结构，橡胶缓冲。
- 行走轮S45C材质，经热处理，另有34CrMo4 (JIS–SCM435, AISI–4135)材质供客户选择。
- 轴心为钢材材质，经热处理。
- 轴承润滑油处理
- 轴承座为铸件材质或钢制材料。

Model 型号	Length 长度 (m)	Power 功率 (kw)	Orbit 轨道 (kg)	Gearwheel Dia. 齿轮直径 (Φ)mm	Output gear 输出齿轮	Cap 承载量 (Ton)	Span 横梁跨距 (m)
STPT-0.75-120	0.75	0.4	9	120	M3	1	6
STPT-1.2-150	1.2	0.4	9	150	M3.5	1.5	6
STPT-1.5-150	1.5	0.4	9	150	M3.5	2	8
STPT-1.8-150	1.8	0.4	9	150	M3.5	2	8
STPT-1.2-180	1.2	0.4	12	180	M3.5	2	8
STPT-1.8-180	1.8	0.4	12	180	M3.5	3	8
STPT-2.0-180	2	0.4	12	180	M3.5	3	10
STPT-2.2-180	2.2	0.4	12	180	M3.5	3	12
STPT-2.0-200	2	0.75	12	200	M3.5	5	12
STPT-2.2-220	2.2	0.75	12	220	M3.5	5	12
STPT-2.5-220	2.5	0.75	12	220	M3.5	7.5	15
STPT-2.2-250	2.2	0.75	15	250	M4	7.5	12
STPT-2.5-250	2.5	0.75	15	250	M4	7.5	15
STPT-3.0-250	3	0.75	15	250	M4	10	15
STPT-2.5-280	2.5	0.75	22	280	M4	10	12
STPT-3.0-280	3	1.5	22	280	M4	10	15
STPT-3.5-280	3.5	1.5	22	280	M4	15	15
STPT-2.5-350	2.5	2.2-1.5	30	350	M5	15	12
STPT-3.0-350	3	2.2-1.5	30	350	M5	15	15
STPT-3.5-350	3.5	2.2-1.5	30	350	M5	15	15

双轨台车

Double Girder Top Running Type Motorized Trolley



- Magnetic Cone Brake provides accurate and reliable stopping, even in the event of a total power loss.
- Simple gear box construction.
- Eccentrically mounted trolley wheels always seek level.
- Push button switches come in a standard 4-button type for combines hoist.
- 电磁制动车准确而可靠的制动。
- 齿轮箱结构简单。
- 小车轮子始终保持水平。
- 配备4点式按钮开关与电动葫芦相连。

Model 型号	Load Capacity 承载量 (Ton)	Speed 速度 (m/min)	Gear Dia. 齿轮直径 (Φ)mm	Motor 马达
DTPT-200	2	20	150-180	0.4KWx4P
DTPT-300	3	20	180	0.4KWx4P
DTPT-500	5	23	200	0.75KWx4P
DTPT-700	7.5	23	240	0.75KWx4P
DTPT-1000	10	18	280	1.5KWx4P
DTPT-1600	16	18	320	1.5KWx4P
DTPT-2000	20	18	380	2.2KWx4P
DTPT-3000	30	18	420	3KWx4P

倒悬挂端梁

Underhung Single Girder End Trucks

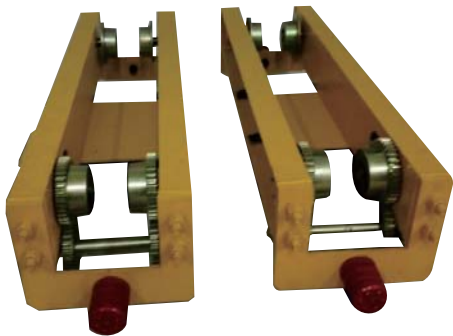

- Capacities 100kg through 5 Ton.
- Provide structural integrity and strength
- Unique side guide rollers reduce wheel friction and allow smooth crane travel
- Suitable for use on S or W shaped runway beams
- Rail sweeps, drop stops and rubber bumpers are standard equipment
- 适用于起重量：100kg–5Ton
- 结构完整，安全性高
- 独特的边轮设计以减少摩擦，使起重机运行顺畅。
- 可适用于” S ” ” W ” 型钢结构

Model 型号	Length 长度 (m)	Power 功率 (kw)	Orbit 轨道 (kg)	Gearwheel Dia. 齿轮直径 (Φ)mm	Output gear 输出齿轮	Cap 承载量 (Ton)	Span 横梁跨距 (m)
SUPT-1.5-145	1.5	0.25	12	145	M3.5	0.5	6
SUPT-2.0-145	2	0.25	12	145	M3.5	0.5	8
SUPT-2.5-145	2.5	0.25	12	145	M3.5	0.5	12
SUPT-2.0-175	2	0.25	15	175	M3.5	1	8
SUPT-2.5-175	2.5	0.4	15	175	M3.5	1	12
SUPT-3.0-175	3	0.4	15	175	M3.5	1	16
SUPT-2.0-195	2	0.4	15	195	M3.5	2	8
SUPT-2.5-195	2.5	0.4	18	195	M3.5	2	12
SUPT-3.0-195	3	0.4	22	195	M3.5	2	18
SUPT-2.5-215	2.5	0.4	22	215	M4	3	10
SUPT-3.0-215	3.0	0.4	22	215	M4	3	14
SUPT-3.5-215	3.5	0.4	22	215	M4	3	18
SUPT-2.5-245	2.5	0.4	24	245	M4	5	10
SUPT-3.0-245	3.0	0.75	24	245	M4	5	14
SUPT-3.5-245	3.5	0.75	24	245	M4	5	18
SUPT-3.0-295	3	0.75	24	295	M4	10	10
SUPT-4.0-295	4	1.1	30	295	M4	10	18

起重机车轮

Machined Steel End Truck Wheels

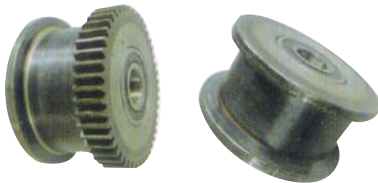

Alloy steel (JIS-S45C) wheel reduces friction between wheel flanges and rails giving less wear than normally encountered with other materials.

起重机车轮为合金钢（JIS–S45C）可减少车轮轮缘和轨道之间的摩擦。

project Model	Bearing	Gear Teeth	Bearing	HRC Hardness	Wheel Load (mm)	Square Bar (mm)
GW150 PW150	6306Z	M3. 5x40T	S45C	50+5	2100	32
GW180 PW180	6308Z	M3. 5x49T	S45C	50+5	3200	38
GW198 PW198	6308Z	M3. 5x55T	S45C	50±5	4900	38
GW250 PW250	6309Z	M4x60T	S45C	50±5	5700	44
GW300 PW300	6310Z	M4x73T	S45C	50±5	8100	44
GW345 PW345	6311Z	M5x67T	SC49	45±5	9700	55
GW430 PW430	6314Z	M5x84T	SC49	45±5	15000	55
GW545 PW545	6316Z	M5x107T	SC49	45±5	19000	63

KBK 柔性轻型组合式悬挂起重机 KBK Light Crane System



KBK Light Suspension Combination Crane system modules main parts are three cold rolled section, light weight, high strength and stiffness to ensure stability of the system
Load capacity 125kg up to 1,000 kg
Extremely smooth travel, low noise levels
Fast and simple installation and conversion
Ergonomic load handling for even heavy loads
KBK 柔性轻型组合式悬挂起重机系统模块的主体是三种规格的冷轧型材，强度大、刚性好、自重轻，保证了系统的稳定性，吊装重量从125kg-2ton，使用范围广泛，尤其用于流水线。
KBK 型材及个标准模块之间只需要用螺栓连接即可使用，安装方便，经济高效。

起重量Capacity(kg)	125	250	500	1000
尺寸 (Dimension)				
L	9050	8050	7050	4050
LK	8500	7500	6500	3500
L2	95	95	95	220
L3	645	585	525	470
B	190	190	190	460
H	1308	1378	1348	1471
h	735	735	735	749

悬臂起重机 Jib Crane

Vanbon jib cranes packages can be mounted to your facility wall, foundation or floor .
They are very easy to install, use, and even relocate in your work environment. Their application can adapt with your changing needs.
Designed specifically for use with the Loadmate.
Wall mounted or free-standing — over braced or under braced.
Jib crane packages available fully tested, single sourced with festoon, hoist and jib.
悬臂起重机是为适应现代化生产而制作的新一代轻型吊装设备,配合了可靠性高的环链电动葫芦尤其适用于短距离，使用频繁，密集性吊运作业，具有高效、节能、省事、占地面积小，易于操作与维修等特点。
悬臂起重机包括：
定柱式悬臂起重机：起重量在125Kg-5000Kg，结构新颖、合理、简单、操作方便、回转灵活、作业空间大
移动式悬臂起重机，起重量125KG到500KG，灵活机动、适应性广
墙壁式悬臂起重机等：起重量125KG到3000KG，起升高度为3米。



工厂一览 Factory >>>

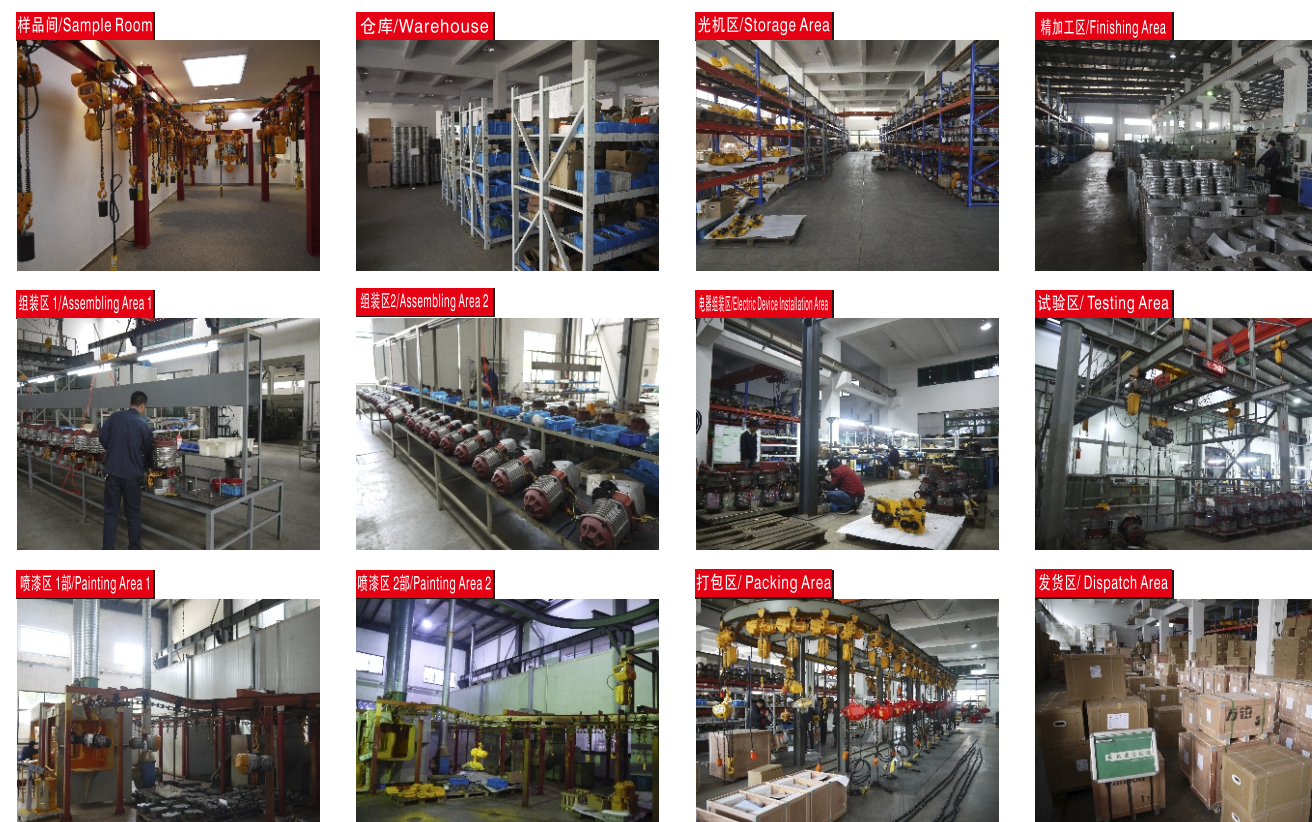

工程案例 Cases >>>

